

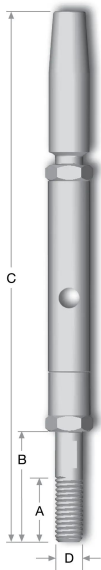

# Classic Turnbuckle for Cement Posts



Electroline's Architectural Classic Turnbuckle Assembly is used to create tension in the wire railing when attached in a straight line with a cement post. The swageless termination allows it to quickly be attached to the end of a wire, with the other end anchored into the post. The body is rotated to tension the cable railing.

## Available Products

Rope Size (In.)	Part No.	Dimensions (In.)				Takeup
		A	B	C	D	
3/16	CE-418-CEM	5/8	1-1/2	6-1/2	1/2\"-13	2-1/8
1/4	CE-425-CEM	7/8	1-1/2	7-3/16	1/2\"-13	2-1/8

PDF generated on 2026-01-18 at 06:31 by [electrolineusa.com](https://electrolineusa.com). Information is provided for reference only. Please contact Electroline at [info@electrolineusa.com](mailto:info@electrolineusa.com) or 1-800-321-0870 to confirm specifications or discuss customization options.